

Specification sheet

REV.1

VAL 100CY R20
Surface Cylinder, length 200mm

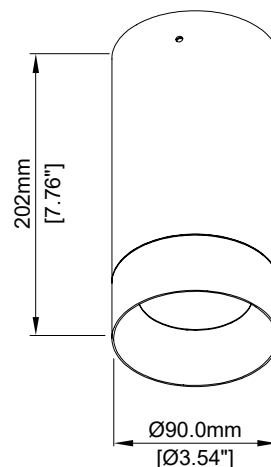

Description

VAL100 is a MACRON solution for high-performance cylinder applications. The 200 mm version can drive upto 30W and deliver unmatched 2200 lm from a 3.5" (90 mm) aperture. VAL100 also features integrated drivers with 3-in-1 dimming technology, that are best suitable for open-ceiling applications. Twist-lock installation mechanisms, best-in-class lighting quality, and sleek aesthetics and finishes are just some details that distinguishes MACRON philosophy from others. VAL family is designed to integrate and complement your architectural aspiration.

Features

LED	Lumiled Luxeon COB1205
Color temperature	2700K/ 3000K/ 3500K/ 4000K
Optics	Spot 20° / Medium 25° / Wide 34° / Flood 55°
Driver	Integrated class 2 driver, power factor >0.90 Tri-dimmable, TRIAC/ ELV10-10V

Performance

Delivered output	Up to 2100 lm(90+ CRI)
Power consumption	29 W
Color rendering	90+ CRI
CBCP	Spot 8074cd / Medium 5818cd / Wide 4090 cd / Flood 2517 cd
Lumen maintenance	L80, B10 50,000 hrs

Ordering Code Information

PRODUCT	SHAPE	LENGTH	COLOR TEMPERATURE	FINISH	BEAM ANGLE	COLOR RENDERING	INPUT/DIMMING
VAL 100 CY	R	20	27	WHBK	S	9	3AE
VAL 100 CY, Cylinder Surface Mount	R (Round)	20 (200mm)	27 (2700K) 30 (3000K) 35 (3500K) 40 (4000K)	WHBK (White/Black) BKGD (Black/Gold) BKBK (Black/Black)	S (Spot / 20 deg.) M (Medium / 25 deg.) W (Wide / 34 deg.) F (Flood / 55 deg.)	9 (90 CRI+)	3AE (120-277V) TRIAC (ELV 10-10V Dimming)

Electrical and Control

Input voltage	140V-277V
Control	TRIAC/ELV/0-10V Dimming
Feature	Overload & short circuit protection

Construction

Material	Casting & Extrusion grade Aluminum Alloy
Finishes	Black body with gold trim/ Black body with black trim/ White body with black trim
Optics	Field Interchangeable optics

Rating/ Certification/ Warranty

- Dry and damp Locations
- RoHS compliant
- 5 years/ 50,000 hrs warranty

Specification sheet

REV.1

VAL 100CY R20
Surface Cylinder, length 200mm

Photometrics

16W | 90CRI | 3000K | White body with Black trim

MULTIPLYING FACTORS: (Multiplying Factor is based on 3000K-90+CRI IES file on website)

CCT	2700K-80+	3000K-80+	3500K-80+	4000K-80+
Factors	1.11	1.16	1.18	1.21

CCT	2700K-90+	3000K-90+	3500K-90+	4000K-90+
Factors	0.96	1.0	1.04	1.08

Spot 20°

Delivered Ourput : 1888 lm | CBCP : 8074cd | Beam Angle : 20°

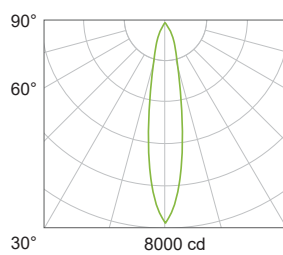

Center Beam Intensity	Beam Width	Height
8090 lx	36cm	1m
2022 lx	72cm	2m
899 lx	108cm	3m
507 lx	144cm	4m
323 lx	180cm	5m

Medium 25°

Delivered Ourput : 1942 lm | CBCP : 5818 cd | Beam Angle : 25°

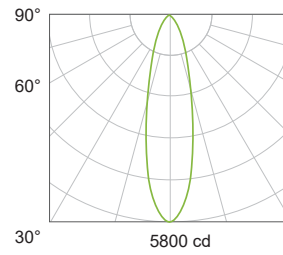

Center Beam Intensity	Beam Width	Height
5834 lx	45cm	1m
1458 lx	90cm	2m
648 lx	135cm	3m
365 lx	180cm	4m
233 lx	225cm	5m

Wide 34°

Delivered Ourput : 1932 lm | CBCP : 4090cd | Beam Angle : 34°

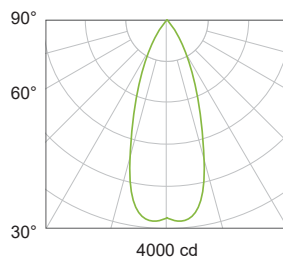

Center Beam Intensity	Beam Width	Height
4197 lx	64cm	1m
1049 lx	129cm	2m
466 lx	194cm	3m
262 lx	259cm	4m
167 lx	323cm	5m

Flood 55°

Delivered Ourput : 2112 lm | CBCP : 2517 cd | Beam Angle : 55°

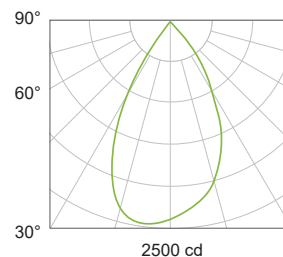

Center Beam Intensity	Beam Width	Height
2578 lx	106 cm	1m
644 lx	212 cm	2m
286 lx	318 cm	3m
161 lx	423 cm	4m
103 lx	529 cm	5m

Optional Accessory

Product	Canopy size	FINISH
VAL 100 CY	5-2 PL	WH
VAL 100 CY, Cylinder Surface Mount	5"-2" conversion canopy kit	WH White BK Black

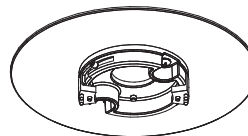

Product	ACC.
VAL 100	HCL
VAL 100	HCL Honey Comb Louver

